



1 FRONT ELEVATION



3 RIGHT ELEVATION

COLOR SCHEME KEY

- | | |
|---|---|
| 1 | MAIN
SW 7757
HIGH REFLECTIVE WHITE |
| 2 | TRIMS
SW 7646
FIRST STAR |
| 3 | DETAIL COLOR
SW 7648
BIG CHILL |
| 4 | AWNING/BRACKETS
SW 7104
COTTON WHITE |
| 5 | RAILING/WINDOWS/
DOOR FRAMES
SW 7048
URBANE BRONZE |
| 6 | SHUTTERS/GARAGE DOORS
SW 9177
SALTY DOG |
| 7 | ROOFS
BARREL TILES
HUES OF CHARCOAL |
| 8 | STONE VENEER
FRENCH LIMESTONE CREAM |

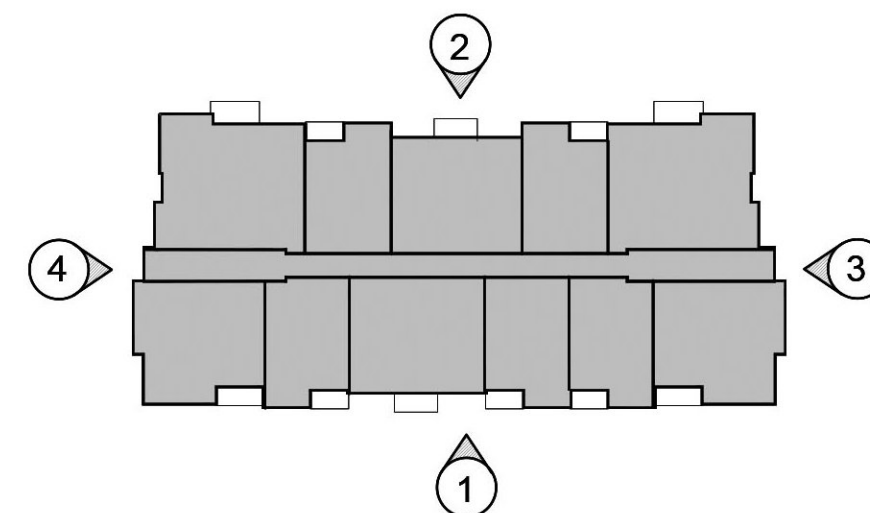

KEYPLAN

N.T.S.
BLDG IB ELEVATIONS

SCALE: 1/8"=1'-0" PZ23-12000017

P&Z

	BY
PRE-APP MEETING 04/04/2023	
DRC SUBMITTAL 06/13/2023	
DRC RE-SUBMITTAL 08/16/2023	
DRC RE-SUBMITTAL 01/01/2024	
DRC RE-SUBMITTAL 10/16/2024	
DRC RE-SUBMITTAL 12/10/2024	
DRC RE-SUBMITTAL 01/29/2025	

OAKS @ PALM AIRE

FOR:
MORGUARD
LOCATED AT:
POMPANO BEACH, FLORIDA

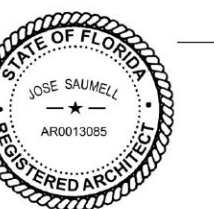

JOSE I. SAUMELL
AR0013085

MSA ARCHITECTS, INC.
A40000895

MSA ARCHITECTS
ARCHITECTURE & PLANNING

DRAWN: JAV
CONTRACT DATE: 10/12/22
SCALE: AS SHOWN
JOB NO.: 2181.PRJ
SHEET TITLE:

BLDG ELEVATIONS

SHEET NUMBER:

A-3.1.1B

06-25-2025